

**DIOCESAN SCHOOL OLD BOYS' ASSOCIATION LTD.**  
**("DSOBA")**  
**HONG KONG**



**CAR PARKING LABELS (FOR SUNDAYS ONLY)**

To : DSOBA Members

DSOBA members who wish to apply for a School Car Parking Label (Sundays only) ("**Label**"), please complete the return slip with a fee of HKD400 for one year (from 01 Jan to 31 Dec).

Please note the following terms:

1. Each DSOBA member is entitled to only ONE Label.
2. All Labels are entitled to ONE parking spot at School on Sundays subject to availability on a first-come, first-served basis.
3. All Labels are to be renewed annually by members.
4. All Labels are non-transferrable and application fee is non-refundable.

Please mail the return slip to the DSOBA office [Address: DSOBA, 131 Argyle Street, Mongkok, Kowloon, Hong Kong.], **together with your self-addressed return & stamped envelope.**

Payments can be settled by cheque or bank transfer:

- Cheque - crossed and made payable to "Diocesan School Old Boys' Association Limited".
- Bank transfer - HSBC bank account (Number is 111-170-312-001 and the name is Diocesan School Old Boys' Association Limited) and provide the transfer receipt.

Yours sincerely,

Anthony Teoh '92  
Chairman  
Sports-Activities Sub-Committee

Lambert Lui '95  
Vice Chairman  
Sports-Activities Sub-Committee

---

**Return Slip**

To: Sports Activities Sub-Committee  
Diocesan School Old Boys' Association Ltd.  
131 Argyle Street, Mongkok, Kowloon.

Ref. No.: \_\_\_\_\_

Name .....

Membership No. ....

Address .....

Car Licence No. ....

.....

Contact No. ....

Signature .....

Date .....



## Notice on Visitor Parking

To ensure an unobstructed Emergency Vehicle Access (EVA)<sup>1</sup>, the following parking measures will continue to be enforced, effective from 1 January 2024.

**Zone A - No visitor parking at all times**, except for service, staff, and resident vehicles.

**Zone B - Visitor parking allowed** during authorized hours.

**Zone A** includes driveways alongside the SIP building, Glass Pavilion, tennis courts, Sports & Dormitory building, Chapel, IB building, gate, and the parking area behind the tuckshop.

**Zone B** includes the Grass Paving Area, such as parking spots outside the auditorium, school field, and PD roundabout.

Thank you for your cooperation.

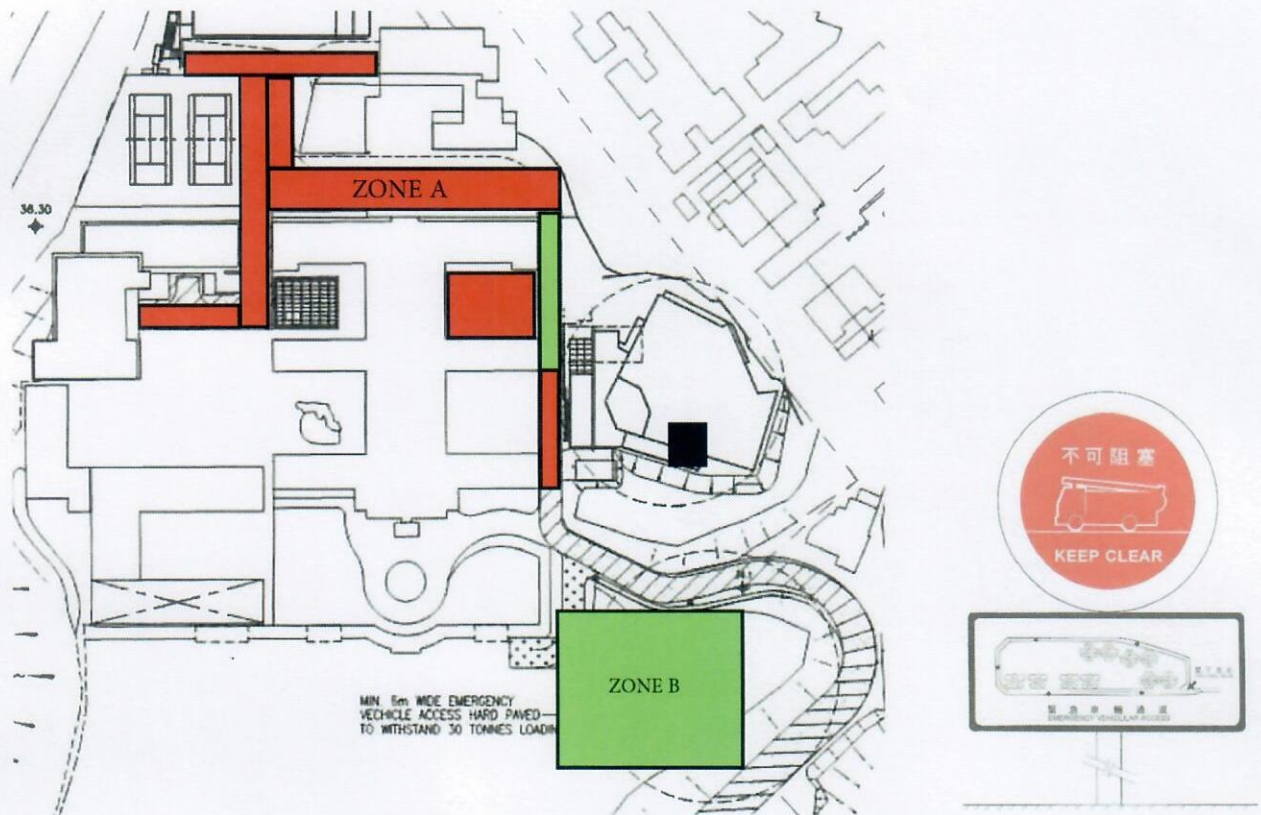

<sup>1</sup> **Obstruction of means of escape** - In relation to any premises, a person commits an offence if the person— (a) sets out or leaves or causes to be set out or left; or (b) being the owner, tenant, occupier or person in charge of the premises, permits or suffers to be set out or left, any article or thing that obstructs or may obstruct the means of escape in respect of the premises. A person who commits an offence under this section shall be liable— (a) on a first conviction, to a fine at level 6; (b) on a subsequent conviction, to a fine of \$200,000 and to imprisonment for 1 year, and, in any case, to a further fine of \$20,000 for each day during which the offence continues.